

Assigned spaces

EVENTS CENTER

BALLY'S  
LAS VEGAS, NEVADA

GRANI

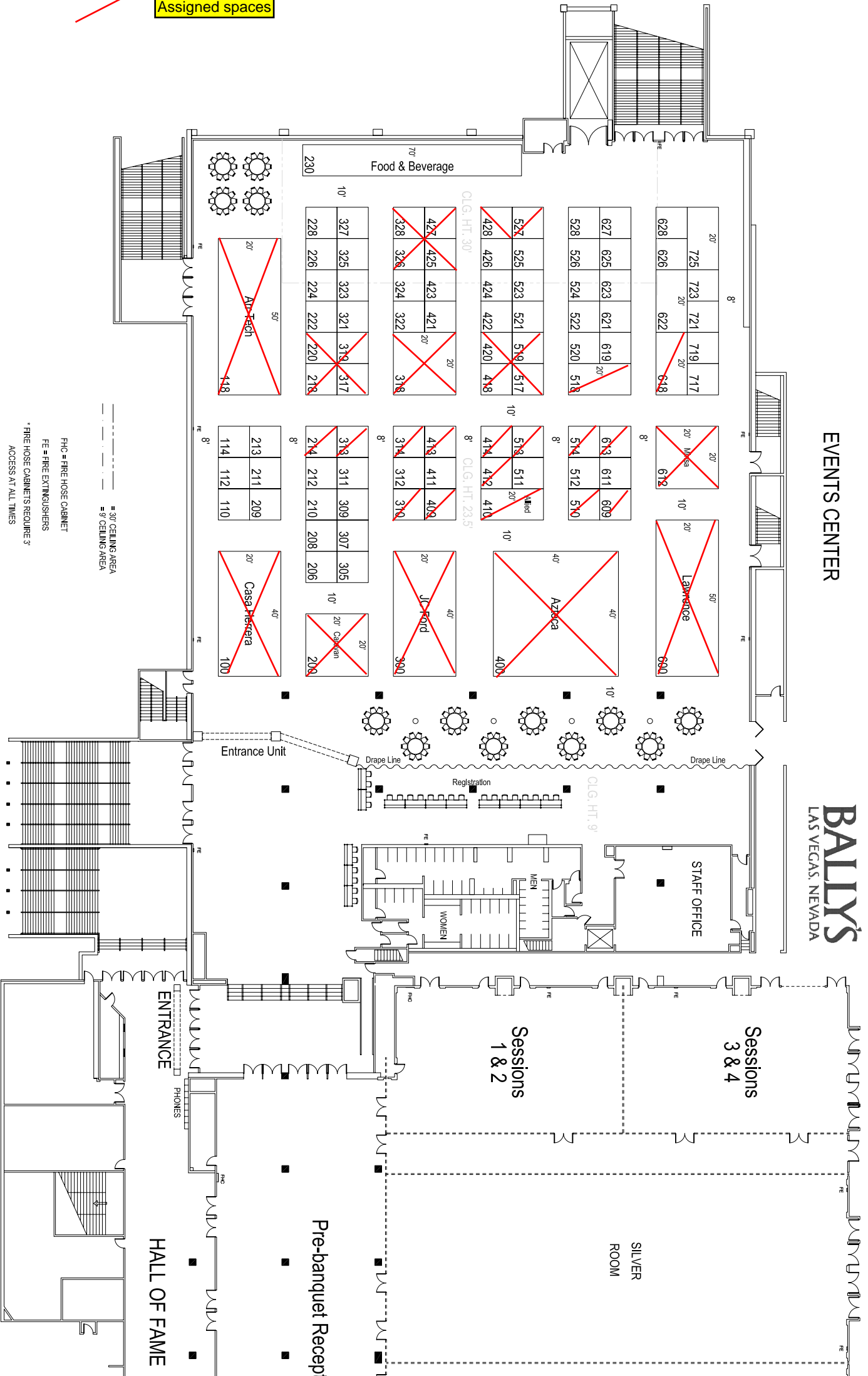

--- = 30' CEILING AREA  
- - - = 9' CEILING AREA

FHC = FIRE HOSE CABINET  
FE = FIRE EXTINGUISHERS  
\* FIRE HOSE CABINETS REQUIRE 3' ACCESS AT ALL TIMES

ENTRANCE

HALL OF FAME

Pre-banquet Recep

Sessions 1 & 2

Sessions 3 & 4

SILVER ROOM

STAFF OFFICE

WOMEN

MEN

Registration

Entrance Unit

PHONES

Drape Line

Drape Line

19TH ANNUAL TORTILLA INDUSTRY ASSOCIATION  
CONVENTION AND TRADE EXPOSITION

**THE FUTURE  
IS NOW**

BALLY'S LAS VEGAS SEPT. 29 - OCT. 1, 2008



<b>Booth space</b>	<b>Exhibiting Organization</b>
428	21st Century Grain Processing
409	AC Horn
410	Allied Blending & Ingredients
519,517,420,418	AM Manufacturing
118	Arr-Tech
400	Azteca Milling, LP
609	Bagcraft
200	Caravan Ingredients
100	Casa Herrera Inc.
314	Elway Industries, Inc
613	Fredman Bag
412	Greenbelt Industries
319,317,220,218	Heat and Control
214	Innoseal
414	J Rettenmaier USA L.P.
300	JC Ford Co
518	Kwik Lok
600	Lawrence Equipment
612	Minsa Corporation
413	O'Malley Grain, Inc
310	Sunopta
527	TACONIC
618	Urshel Laboratories Inc
510	Wirebelt
513	TIC Gums
313	Fleischmann's Yeast